

# INSTALLATION GUIDE 400 x 1200 mm module

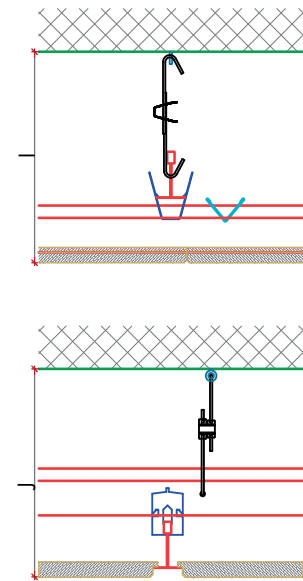
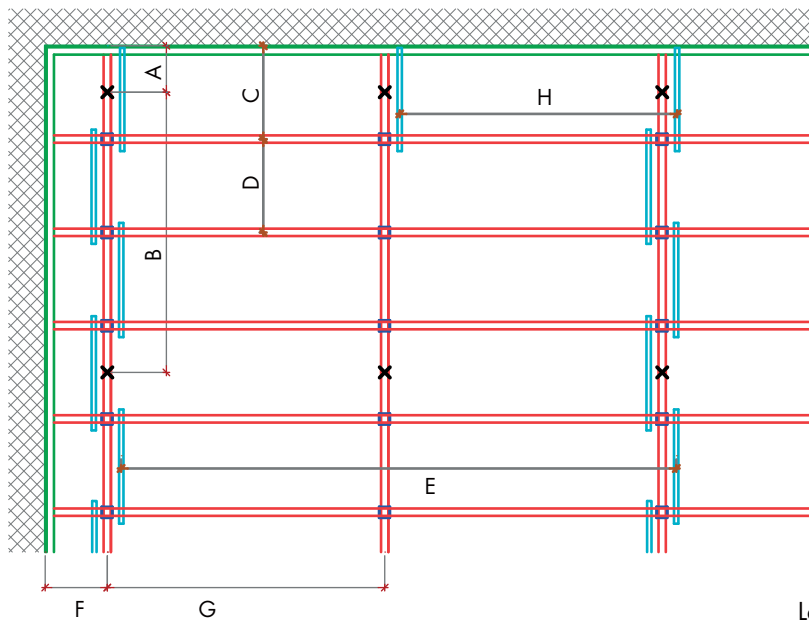

- A = Max. 200 mm
- B = Max. 1200 mm
- C = Max. 400 mm
- D = Max. 400 mm
- E = Max. 2400 mm
- F = Max. 200 mm
- G = Max. 1200 mm
- H = Max. 1200 mm
- I = Min. 100 mm
- J = Min. 100 mm

## Legend:

- Shadow line trim
- Main runner T24
- Spacer bar
- X Adjustable hanger (type depends on installation depth)
- DG Clips

Fig. 1

Best Practice: Use of clean cotton gloves when handling product elements will ensure a good result and a ceiling without fingerprints.

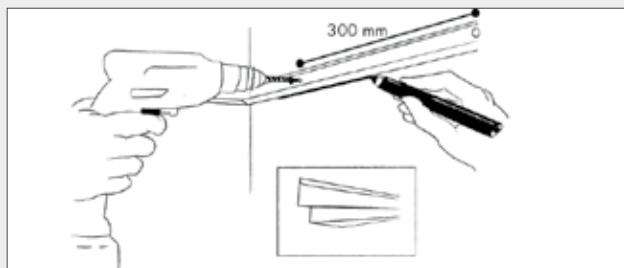

## MARKING AND SHADOW LINE TRIM

- Mark the location of the shadow line trim on the walls and columns in relation to the required ceiling height.
- Install the shadow line trims at max. 300 mm c/c. Choose the method of securing the profiles in accordance with the substrate.

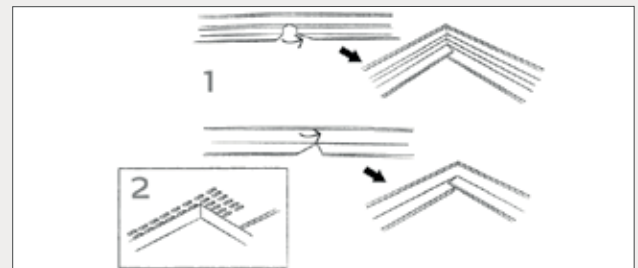

## CORNERS

- Inside corners (1): cut the corners in a false mitre letting the ends overlap each other, unless anything to the contrary is specified.
- Outside corners (2): must always be mitred.

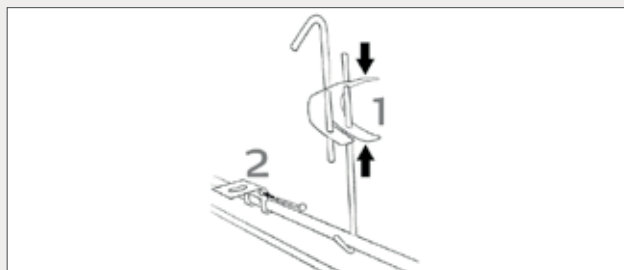

## HANGERS

- Fix adjustable hangers (1) with eye screws or similar securely fastened to the primary construction.
- Direct hangers (2) are secured to the ceiling using appropriate fixings in accordance with the substrate and locked to the main runner with a nail.
- Install the first hanger at max. 200 mm from the wall. The other hangers should be installed at max. 1200 mm c/c.
- If loads from light fittings etc. are to be borne by the ceiling, install additional hangers.
- Refer to distances in figure 1.

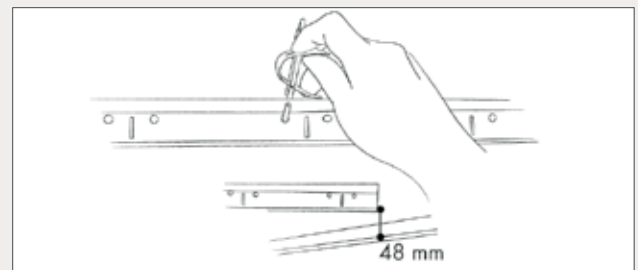

## PRIMARY RUNNERS

- Install the runners with the help of hangers. Note that the location of light fittings and ventilation units will have an influence on ceiling layout.
- The lower edge of the primary runner must be 48 mm higher than the height of the finished ceiling.
- Adjust the height of the primary runners before installing the secondary runners.

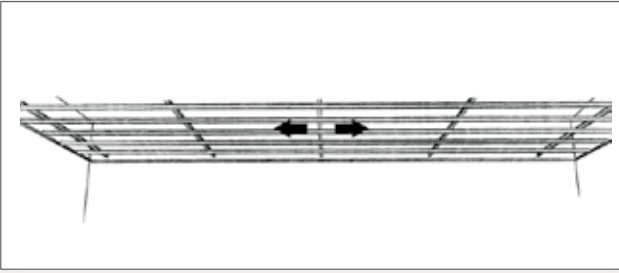

LAYOUT

- Install the secondary runners parallel to each other.

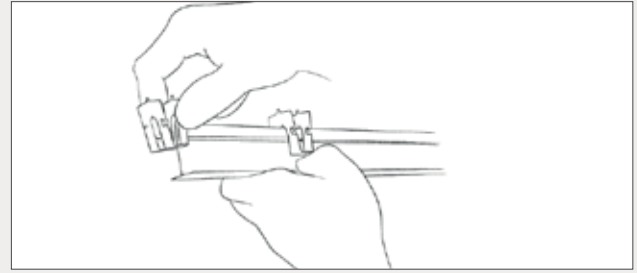

DG CLIPS

- Slide the number of clips necessary over the secondary runner.

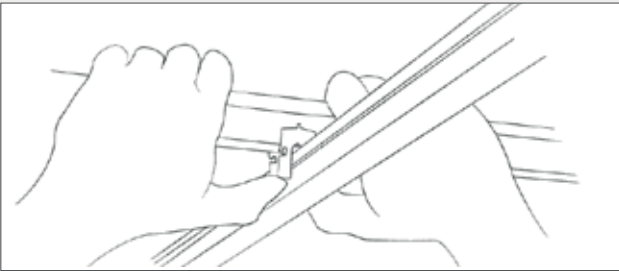

SECONDARY RUNNERS

- Press the DG clip up around the flanges on the primary runner.
- The secondary runner can then be adjusted in both directions.

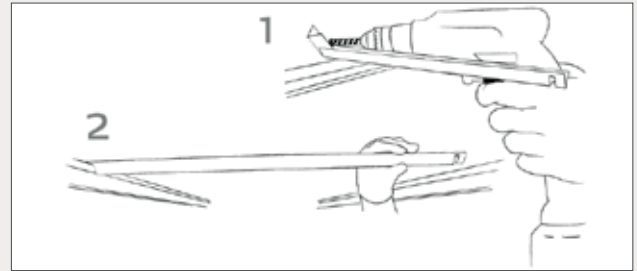

SPACER BARS

- Align the first primary runner along one wall and secure it with the help of adapted spacer bars, which must be screwed to the wall (1).
- Install the remaining spacer bars (2).
- Lock the secondary runner in position by gently pulling them down.

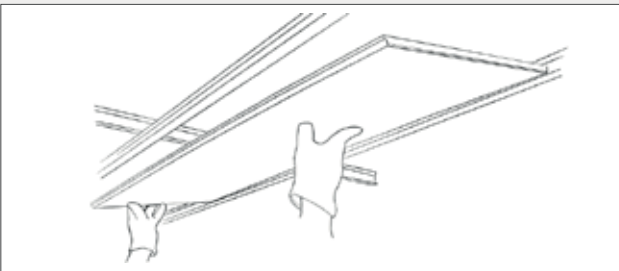

INSTALLATION

- Always wear clean cotton gloves when handling ceiling elements.
- Install the elements by lifting one side of the tile across the flange of the secondary runner, lifting the opposite side and pulling it back so that the tile is resting on its top lip.

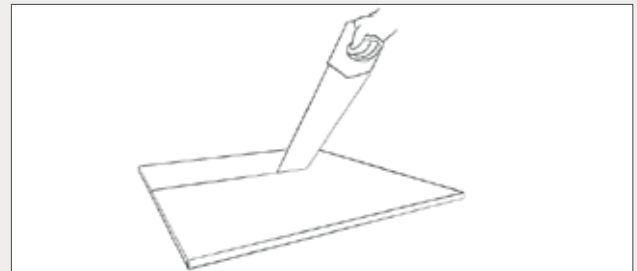

CUTTING

- Cut the elements to size from the front with a fine-toothed saw.
- It is important to cut the tiles in the first and last rows precisely so that they are securely positioned in the system.

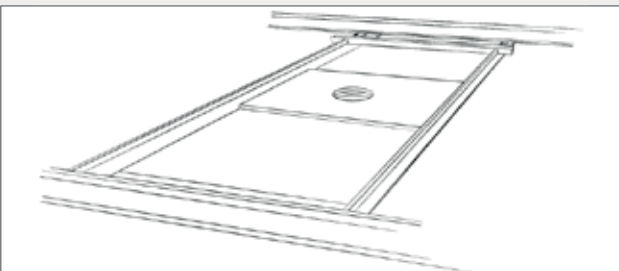

FIXTURES AND FITTINGS

- With smaller units (of up to 3kg) a reinforcement panel of sufficient strength can be installed behind the Visona element.
- The reinforcement panel must extend all the way into the main runners, so that the weight is transferred to them.
- The total weight should not be greater than 3kg for each m<sup>2</sup> of ceiling. Where loads are greater than 3kg/m<sup>2</sup>, additional hangers must be used.
- Units over 3kg, should be installed independently, so that they do not place any load on the ceiling.